

Baker SPD Centrifugal Pump

Introducing Another Quality Product
The MUD HOG™ Centrifugal Pump



Baker Oil Tools
BAKER SPD

Baker SPD - Centrifugal Pump Parts

Centrifugal Pump Shaft

Baker SPD assures the performance of the pump shaft by specifying the highest quality, fatigue-resistant alloy steel, which is machined. The shaft is designed to transmit the required horsepower for maximum output in the most severe applications.

Centrifugal Pump Impeller

A semi-open design has been selected for sizes from 5 x 4 x 14 in. through 8 x 6 x 14 in. The semi-open vane design provides efficient fluid intake and discharge through the power side of the impeller. The impeller is designed with back vanes, which reduces wear on the stuffing box face. The back vanes also reduce wear by limiting the inflow of solids to the stuffing box, which increases mechanical seal life.

Centrifugal Pump Mechanical Seal

Baker SPD has a premier, heavy-duty tungsten carbide seal. The seal face is highly polished tungsten carbide on tungsten carbide. Viton® bellows allows expansion without binding and provides high temperature resistance. Flexible bellows design allows spring force to easily move seal faces together for extended seal life.

Centrifugal Pump Shaft Sleeve

A protective sleeve is designed to cover and protect the shaft from abrasive fluids. The sleeve is made from ceramic-coated 416 stainless steel or uncoated steel when used with mechanical seal.

Centrifugal Pump Wear Pad

Replaceable wear pads are available to extend the life of casings. Baker SPD casings are designed with wear pads in sizes 4 x 3 x 13 in. through 8 x 6 x 14 in. Wear pad repair kits include studs and stainless steel nuts to assure ease of replacement.

Centrifugal Pump Bearings

Baker SPD specifies bearings of the highest quality from premier bearing manufacturers. The bearings are interchangeable with other popular 2.5 in. pump models. The outboard bearing is a duplex configuration with angular ball contact to satisfy the maximum power input requirement. The inboard bearing is a double row angle contact configuration for maximum run life.

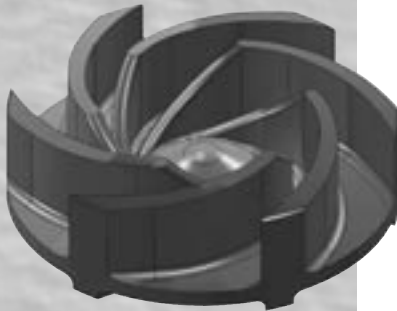
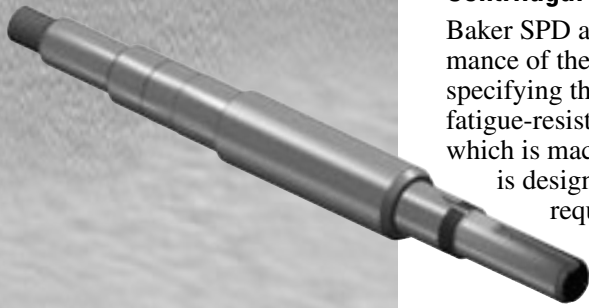

Baker SPD Centrifugal Pump, the MUD HOG™



Baker Oil Tools
BAKER SPD